



# PMP-100GPD

## BOOSTER PUMP



### PMP-100GPD SPECIFICATIONS

<b>MODEL NUMBER:</b>	PMP-100GPD
<b>PUMP DESIGN:</b>	Positive displacement
<b>DIAPHRAGM PUMP:</b>	Three chamber
<b>MOTOR:</b>	Permanent magnet
<b>VOLTAGE:</b>	24 VDC
<b>PRESSURE SWITCH:</b>	None
<b>LIQUID TEMPERATURE:</b>	140° F (60° C) max.
<b>PRIME:</b>	Self-priming up to 2 meter
<b>RUNS DRY:</b>	WITHOUT DAMAGE
<b>PORTS:</b>	3/8"-18 NPT female
<b>NET WEIGHT:</b>	4.67 lbs (2.12 kg)
<b>DUTY CYCLE:</b>	Continuous
<b>TYPICAL APPLICATIONS:</b>	R.O. booster pump and water delivery
<b>BYPASS:</b>	125 psi

### COMPATIBILITY

This pump should be used as a Reverse Osmosis Booster pump for water only.

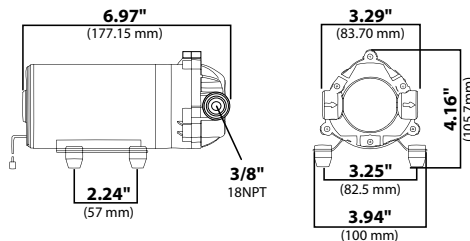

INLET - 8 PSI		
PRESSURE (PSI)	FLOW GPM / (L/min)	CURRENT (AMPS)
Open Flow	0.58 / 2.20	0.15
10	0.52 / 1.95	0.19
20	0.48 / 1.80	0.26
30	0.44 / 1.65	0.33
40	0.41 / 1.55	0.40
50	0.39 / 1.48	0.49
60	0.36 / 1.37	0.56
70	0.34 / 1.27	0.62
80	0.31 / 1.18	0.68
90	0.26 / 1.00	0.73
100	0.18 / 0.69	0.76
110	0.092 / 0.35	0.82
125	BY PASS	1.34

*All data based on testing with water | Voltage (Volts): 24 VDC/1.5A/ Adaptor*

NOTE: Performance will vary with variation in service voltage and transformer output

LIT-PMP-100GPD-DS 09/14/22



AQUATROL | P.O. Box 2235 Chino Hills, CA 91709 • USA

Distributed by:

WWW.AQUATROLTECH.COM